

In-Use Screen

After a Massage program is selected, In-use screen displays all settings to that program.

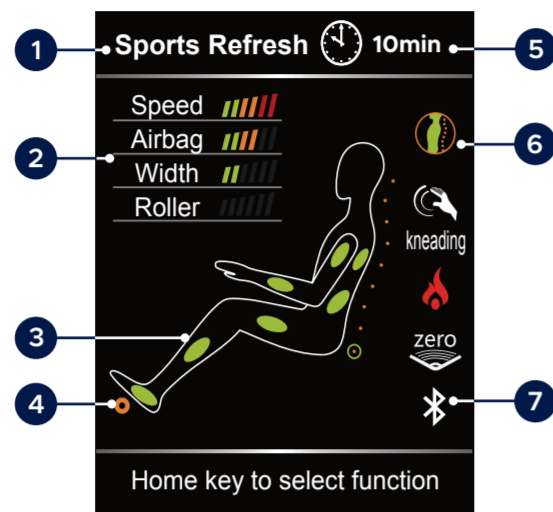

- 1 Program
- 2 Indicators
- 3 Active airbags
- 4 Active rollers
- 5 Time left
- 6 Back-roller position & direction
- 7 Bluetooth connected

Nature Sounds

From the SOUNDS button on the main menu you can select your choice of soothing sound therapy. Adjust volume to one of 5 levels also found under SOUNDS.

- White Noise
- Ocean Surf
- Crickets
- Rain
- Nature
- Airplane
- Car Ride
- Fireplace
- Thunderstorm
- Windy Night

Share a photo and tag us:

@Infinitymassagechairs

@infinity_chairs

@Infinitymassagechairs

Don't forget to use [#lovemyinfinitychair](#)

INFINITY®

72 Stard Road, Seabrook, NH 03874
603-910-5000
www.infinitymassagechairs.com
Version 1.3

INFINITY®

Quick Start Guide

Smart Chair Pro Massage Chair

INFINITY®

Multi-Functional Screen

Use the directional buttons below to navigate these menu screens. Then press OK to select

Power – Powers up the remote or returns the chair to the exit position and powers down remote

Home – Shortcut to the home page of all menu screens

OK – After navigating to the command desired on the display, push OK to select

Heat – Press once to turn heat on and again to turn heat off

Foot Roller – Press to turn off Foot Roller, press again to resume Foot Roller

Feet Adjust – Press and hold up arrow to bring foot rest up, press and hold down arrow to bring foot rest down

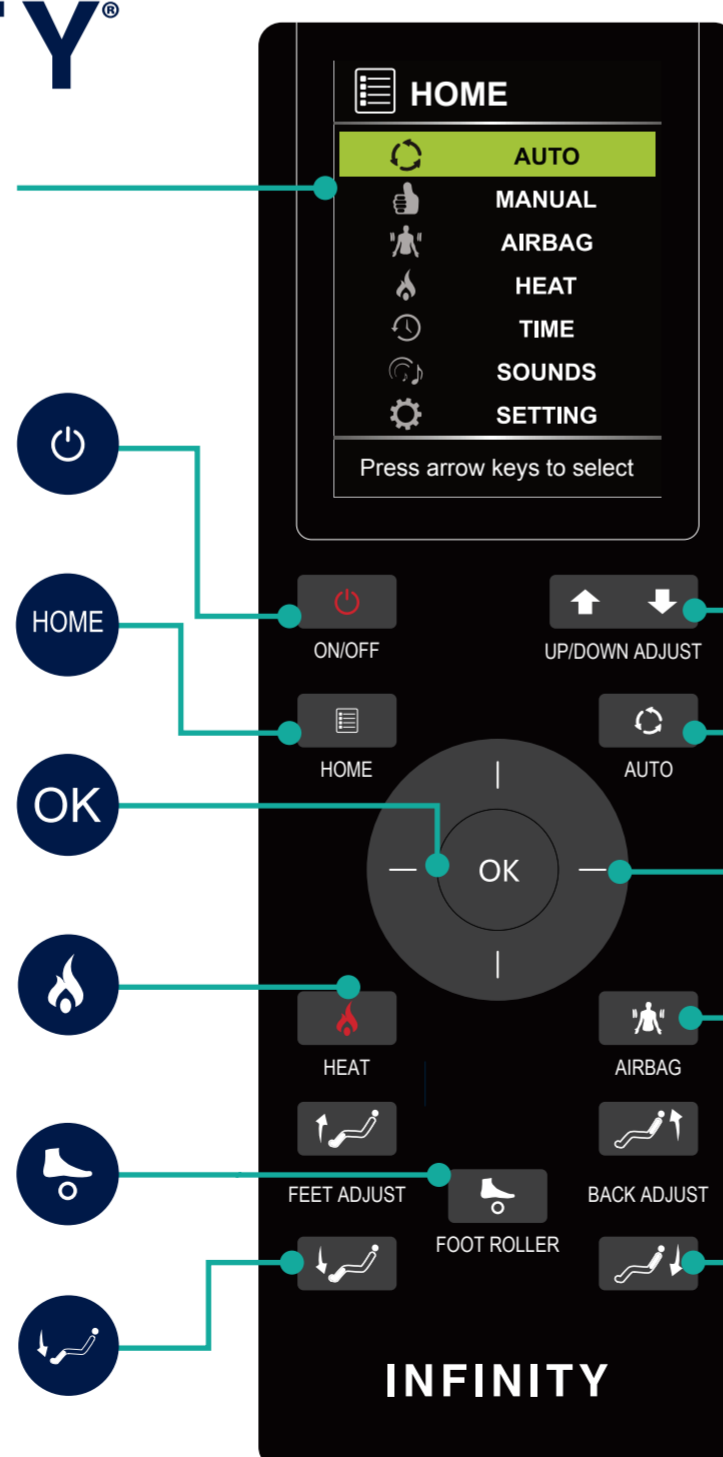

Back Adjustment – Back mechanism position adjustment; press and hold up to raise, press and hold down to lower. Use during initial body scan fine tuning or in manual point zone mode

Auto – Select from seven pre-set massage programs:

- Sports Refresh
- Extension
- Rest & Sleep
- Workign & Relief
- Neck & Shoulder
- Waist & Spine
- Demo

Directional Button – Press up, down, left or right to navigate the display screen

Airbag – Push this button to change the airbag pressure. See Airbag level on Multi-Function Screen to adjust.

Seat Back Position – Press and hold down arrow to recline the seat back, press and hold the up arrow to upright the seat back